

# LED Lighted Stanchion Instruction Manual

01

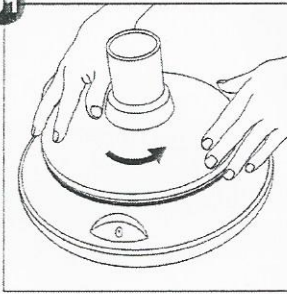

Remove the cap cover by turning it counterclockwise.

02

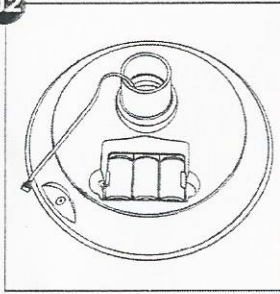

Place 3 size-D batteries into the cell box according to the positive (+) and negative (-) indications shown on the cell box.

03

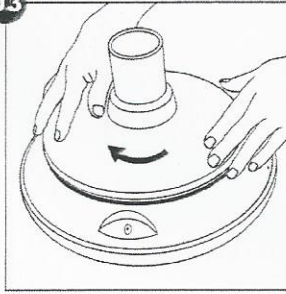

Replace the cap cover back by turning it clockwise.

04

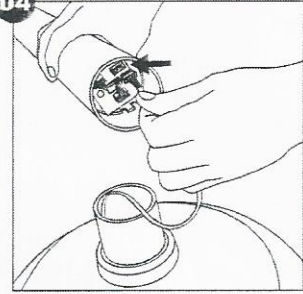

Plug the electric wire into the PC board located at the bottom of the LED post.

05

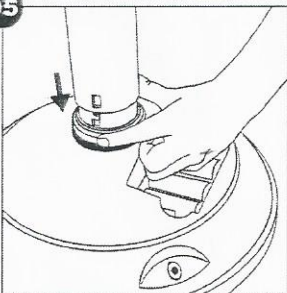

Attach the LED post to the base. Once fasten correctly, a click should be heard.

06

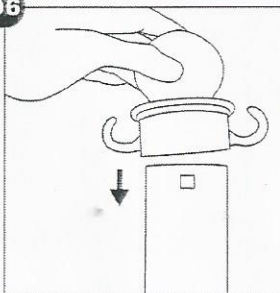

Place the plastic head on top of the LED post.

07

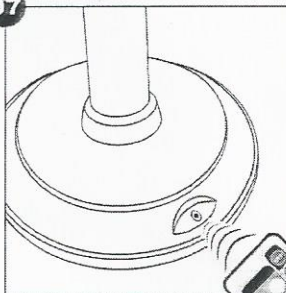

Press any button from the remote control to start your LED lighted stanchion (up to 15 feet).

Note:  
a. To avoid any failure, turn off the power before disassemble.

## Weight Bag

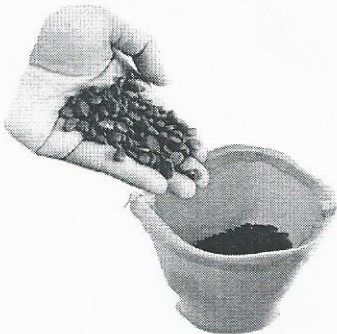

Fill weight bags with either gravel or sand.  
(Note : Limit each bag to 5- 1/2 lbs)

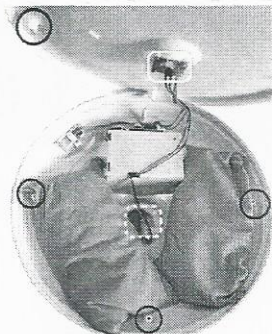

Flip the LED base upside down and unscrew the base cover. Gently place the weight bags in the open areas, make sure to avoid blocking the screw holes and hitting the wires.

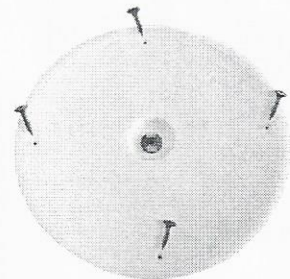

Place the base cover back and align the screw holes. After tighten the screws, your LED lighted stanchion is ready to use.

## LED AC/DC Adapter & Serial Cable

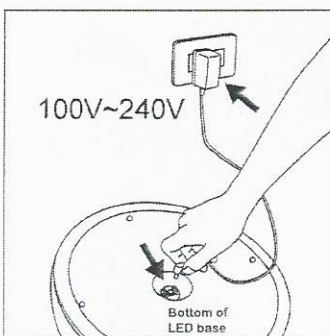

Connect the AC/DC adapter (included)

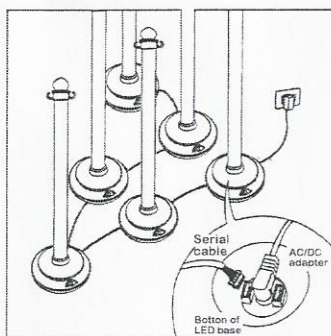

AC/DC adapter: For best lighting quality, limit your connection up to 6 stanchions with serial cable.

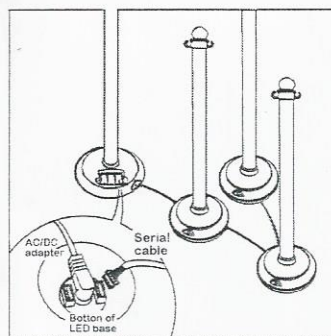

Battery: For best lighting quality, limit your connection up to 4 stanchions with serial cable.

Note:  
a. For safety consideration , please remove all batteries from the cell box before plug into a socket.  
b. serial cable ONLY provide connection up to 6 stanchions.